



OMEGA SD10 SK DUO Vapour Barrier

Weather-resistant 3-layer roof sheeting with vapour delaying effect for all insulation on battens. 2 two-way acrylate adhesive strips are integrated for adhesion at joints.

FIELDS OF APPLICATION

- for over-rafter insulation
- on the room side below the thermal insulation

ADVANTAGES

- lightweight
- tear-resistant
- rigid
- 100% recyclable
- resistant to ageing
- max. 2 months exposure to the elements

RECOMMENDED ACCESSORIES



OMEGA QUILLI



OMEGA Nail-Seal Tape



PE Nail-Seal Tape DSK









AIRSTOP Sealant SPRINT

AVAILABLE IN THE FOLLOWING DIMENSIONS

Roll width	3,0 m
Roll length	50 m
Roll area	150 m ²
Roll weight	27 kg

PRODUCT DATA ACCORDING TO STANDARD EN 13984

Material composition	3-layer PP fleece with two two-way acrylate adhesive strips	
Thickness	ca. 0,75 mm	
Colour	beige	
Weight per unit area	175 (± 5) g/m ²	
Sd - value	10 m (-4 / +8)	
Temperature resistance	- 40 °C - + 80 °C (short-term 100°C)	
UV - resistance	2 months	
Resistance to water penetration EN 1928	W1	
Elongation EN 12311-1	 90 (-40) %	 90 (-40) %
Tensile strength EN 12311-1	 410 (-60) N/ 50 mm	
	 315 (-65) N/ 50 mm	
Tear propagation resistance EN 12310-1	 270 (-70) N	 370 (-120) N
Storage	cool and dry	
Fire performance EN 13501-1/EN 11925-2	E	

05.2020_EN

ISOCELL

GUIDELINES FOR THE USE OF **OMEGA** SD10 VAPOUR BARRIER

APPLICATION

Installation: position on the sheathing with the printed side facing upwards (UV-resistant side). Attach to the wooden subframe using a tackler.

Overlaps and edge joints: min. 10 cm overlap – this is marked on the OMEGASD10 SK DUO Vapour Barrier with green dotted lines.

Using sufficient pressure press together the acrylate strip of one length and the appropriate two-way adhesive strip of the other length. AIRSTOP Sealant SPRINT or OMEGA QUILLI should be used for an airtight seal at joints.

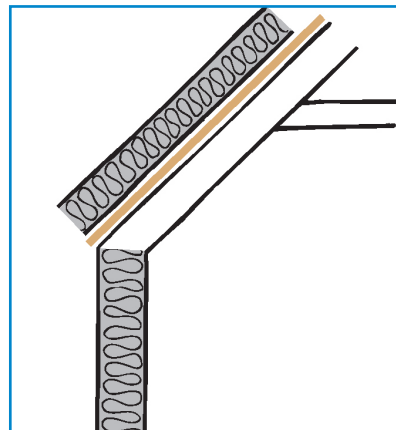

ISOCELL GmbH & Co KG
Gewerbstraße 9
5202 NEUMARKT AM WALLERSEE | Österreich
Tel.: +43 6216 4108 | Fax: +43 6216 7979
office@isocell.at

ISOCELL SCHWEIZ AG
Herbergstrasse 29
9524 ZUZWIL | Suisse /Schweiz
Tel.: +41 71 544 47 20
office@isocell.ch

ISOCELL FRANCE
170 Rue Jean Monnet | ZAC de Prat Pip Sud
29490 GUIPAVAS | France
Tel.: +33 2 98 42 11 00 | Fax: +33 2 98 42 11 99
contact@isocell-france.fr

ISOCELL BUREEL BELGIË
Außenborner Weg 1 | Schoppen
4770 AMEL | Belgique
Tel.: +32 80 39 90 58 | Fax: +32 80 39 97 68
office@isocell.be

ISOCELL Sverige AB
Box 20059
161 02 BROMMA | Sverige
Tel.: +46 10 130 25 00
info@isocell.se

ISOCELL
www.isocell.com