



OMEGA SD10 Vapour Barrier

Weather-resistant 3-layer roof sheeting with vapour delaying effect for all insulation on battens.

FIELDS OF APPLICATION

- for over-rafter insulation
- on the room side below the thermal insulation

ADVANTAGES

- lightweight
- tear-resistant
- rigid
- 100% recyclable
- resistant to ageing
- max. 2 months exposure to the elements

RECOMMENDED ACCESSORIES



OMEGA QUILLI



OMEGA Nail-Seal Tape



PE Nail-Seal Tape DSK



AIRSTOP Sealant SPRINT

AVAILABLE IN THE FOLLOWING DIMENSIONS

Roll width	1,50 m	3,0 m
Roll length	50 m	50 m
Roll area	75 m ²	150 m ²
Roll weight	13,5 kg	27 kg

PRODUCT DATA ACCORDING TO STANDARD EN 13984

Material composition	3-layer PP fleece	
Thickness	ca. 0,75 mm	
Colour	beige	
Weight per unit area	175 (± 5) g/m ²	
Sd - value	10 m (-4 / +8)	
Temperature resistance	-40 °C - +80 °C (short-term 100°C)	
UV - resistance	2 months	
Resistance to water penetration EN 1928	W1	
Elongation EN 12311-1	90 (-40) %	90 (-40) %
Tensile strength EN 12311-1	410 (-60) N/ 50 mm	
	315 (-65) N/ 50 mm	
Tear propagation resistance EN 12310-1	270 (-70) N	370 (-120) N
Storage	cool and dry	
Fire performance EN 13501-1/EN 11925-2	E	

05.2020_EN

ISOCELL

GUIDELINES FOR THE USE OF **OMEGA** VAPOUR BARRIER

APPLICATION

Installation: position on the sheathing with the printed side facing upwards (UV-resistant side). Attach to the wooden subframe using a tacker.

Overlaps and edge joints: min. 10 cm overlap — this is marked on the OMEGA Vapour Barrier with green dotted lines. Overlaps and joints should be sealed airtight with AIRSTOP Sealant SPRINT or with OMEGA QUILLI

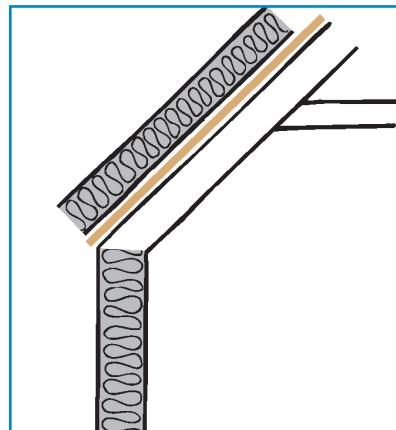

ISOCELL GmbH & Co KG
Gewerbestraße 9
5202 NEUMARKT AM WALLERSEE | Österreich
Tel.: +43 6216 4108 | Fax: +43 6216 7979
office@isocell.at

ISOCELL SCHWEIZ AG
Herbergstrasse 29
9524 ZUZWIL | Suisse /Schweiz
Tel.: +41 71 544 47 20
office@isocell.ch

ISOCELL FRANCE
170 Rue Jean Monnet | ZAC de Prat Pip Sud
29490 GUIPAVAS | France
Tel.: +33 2 98 42 11 00 | Fax: +33 2 98 42 11 99
contact@isocell-france.fr

ISOCELL BUREEL BELGIË
Außenborner Weg 1 | Schoppen
4770 AMEL | Belgique
Tel.: +32 80 39 90 58 | Fax: +32 80 39 97 68
office@isocell.be

ISOCELL Sverige AB
Box 20059
161 02 BROMMA | Sverige
Tel.: +46 10 130 25 00
info@isocell.se

ISOCELL
www.isocell.com